

### 640071

#### HAND OPERATED BEARING PACKER PUMP LUBRICATES BEARINGS WITH I.D. OF 1/2" TO 2"

**IMPORTANT: READ THIS MANUAL CAREFULLY BEFORE INSTALLING,  
OPERATING OR SERVICING THIS EQUIPMENT.**

#### OPERATING PRECAUTIONS

Use ARO replacement parts to assure compatible pressure rating. Read all Warnings and Safety Instructions carefully before operation of this unit.

#### HEED ALL WARNINGS

**⚠ WARNING** PREVENT STATIC SPARKING. If static sparking occurs, fire or explosion could result. Pump dispensing valve, and containers must be grounded when handling inflammable fluids such as petroleum products, paints, lacquers, etc. and whenever discharge of static electricity is a hazard.

**⚠ CAUTION** When pumping, flushing or recirculating volatile solvents, the area must be adequately ventilated.

**⚠ CAUTION** Keep solvents away from heat, sparks and open flames. Keep container closed when not in use.

**⚠ CAUTION** Materials and Solvents being pumped must be compatible with the parts of the pump that become wetted when in contact with material or solvent.

#### RATIO ADJUSTMENT

The Aro Multi purpose hand operated pumps are designed so the ratio can be easily adjusted to handle any viscosity fluids.

The diagram illustrates the location of the linkage to obtain any one of the three different ratios.

The lower the ratio is set, the more volume of fluid will be dispensed with each stroke. However, the heavier the viscosity of the fluid, the higher the ratio should be and the volume per stroke will be reduced accordingly.

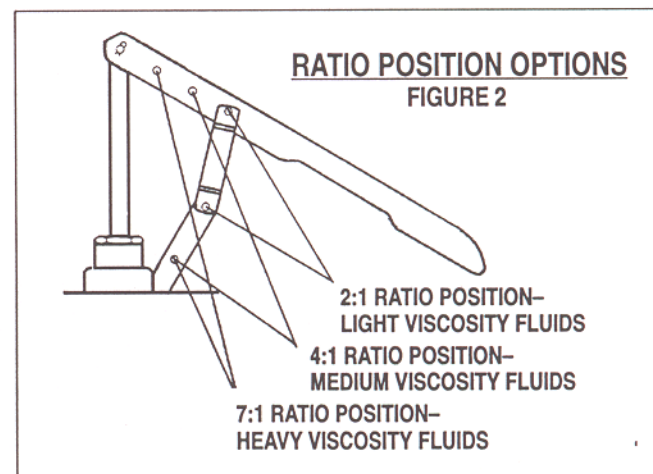
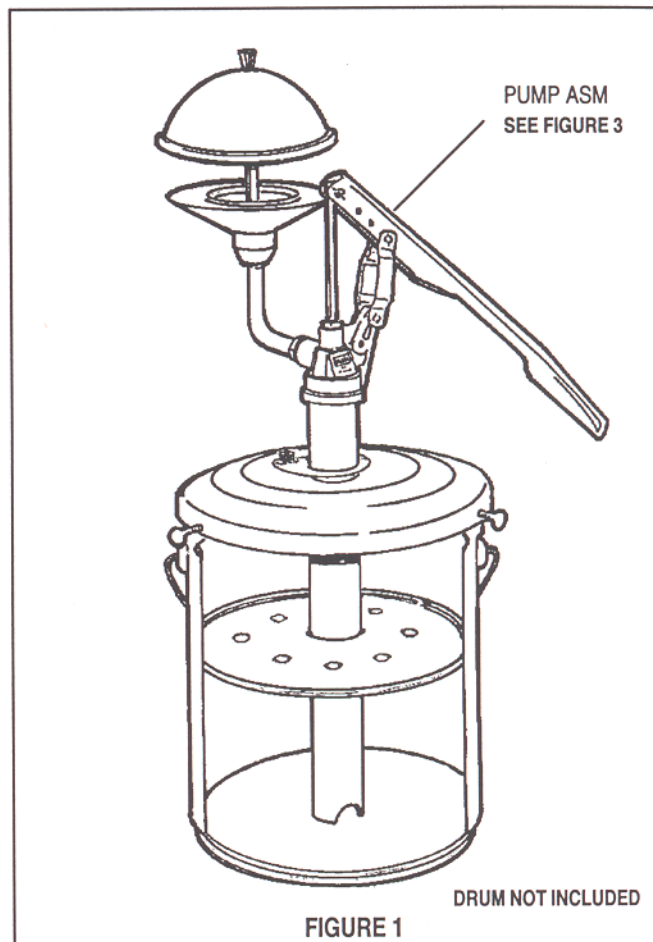

## PUMP ASSEMBLY

- Install hand lever (1) onto the top of the piston rod (23) using a pin (2D). The last hole in the end of the lever should be used.
- The linkage assembly (2B) attaches to the main pump body and the top end of the linkage connects to setting number 7 on the hand lever as shown in Figure 2. **Always install the link so that the arrow on the side points upward.**
- Install the grommet (13B) on the bottom side of the "V" shaped pump holder (13A). Fasten the pump holder to the cover by inserting the pin (13C) and cotter pin (13D).
- Add the thumb screw (13F) to the outside of the cover.
- Place the follower plate (17) in the grease pail so that the rounded side of the follower plate faces down.
- Depress the pump holder and slide the tube (19) through the cover and follower plate. Make sure that the follower plate is resting on top of the grease. Adjust cover to fit the top of the grease pail.
- 

## PARTS LIST

- Reference #'s are shown on the opposite page.

ITEM	Description	(Qty)	Part No.		ITEM	Description	(Qty)	Part No.
1	Hand Lever	(1)	72001-1		13C	Rivet	(1)	72048
2	Link and Pin Assembly	(1)	72062		13D	Cotter Pin	(1)	Y15-31
2A	Pin (9/32 X 7/8)	(1)	72833		13E	Cover	(1)	72004
2B	Link Assembly	(1)	72027		13F	Thumb Screw	(3)	Y66-255-C
2C	Hairpin Retainer	(3)	72835		14	Valve Plate	(1)	72042
2D	Pins (9/32 X 1 1/8)	(2)	72834		15	Seal	(1)	72061
3	Gland	(1)	72058		16	Valve Body	(1)	72017
4	Packing	(2)	72021		17	Follower Plate Assembly	(1)	640095-3-B
5	Pump Body	(1)	72012		18	Foot Valve Body	(1)	72046
6	Bushing	(1)	Y45-6-C		19	Tube	(1)	72019-1
7	Nut	(1)	71489		20	Nut	(1)	Y11-106-C
8	Knob	(1)	76336-1		21	Washer	(1)	Y1-616
9	Screw	(1)	Y3-105-C		22	Spring	(1)	72018
10	Cone Assembly	(1)	71972		23	Rod	(1)	72022-1
11	Cup Assembly	(1)	71976					
12	Outlet Pipe	(1)	71442					
13	Cover Assembly	(1)	72006					
13A	Pump Holder	(1)	72052					
13B	Grommet	(1)	72047					

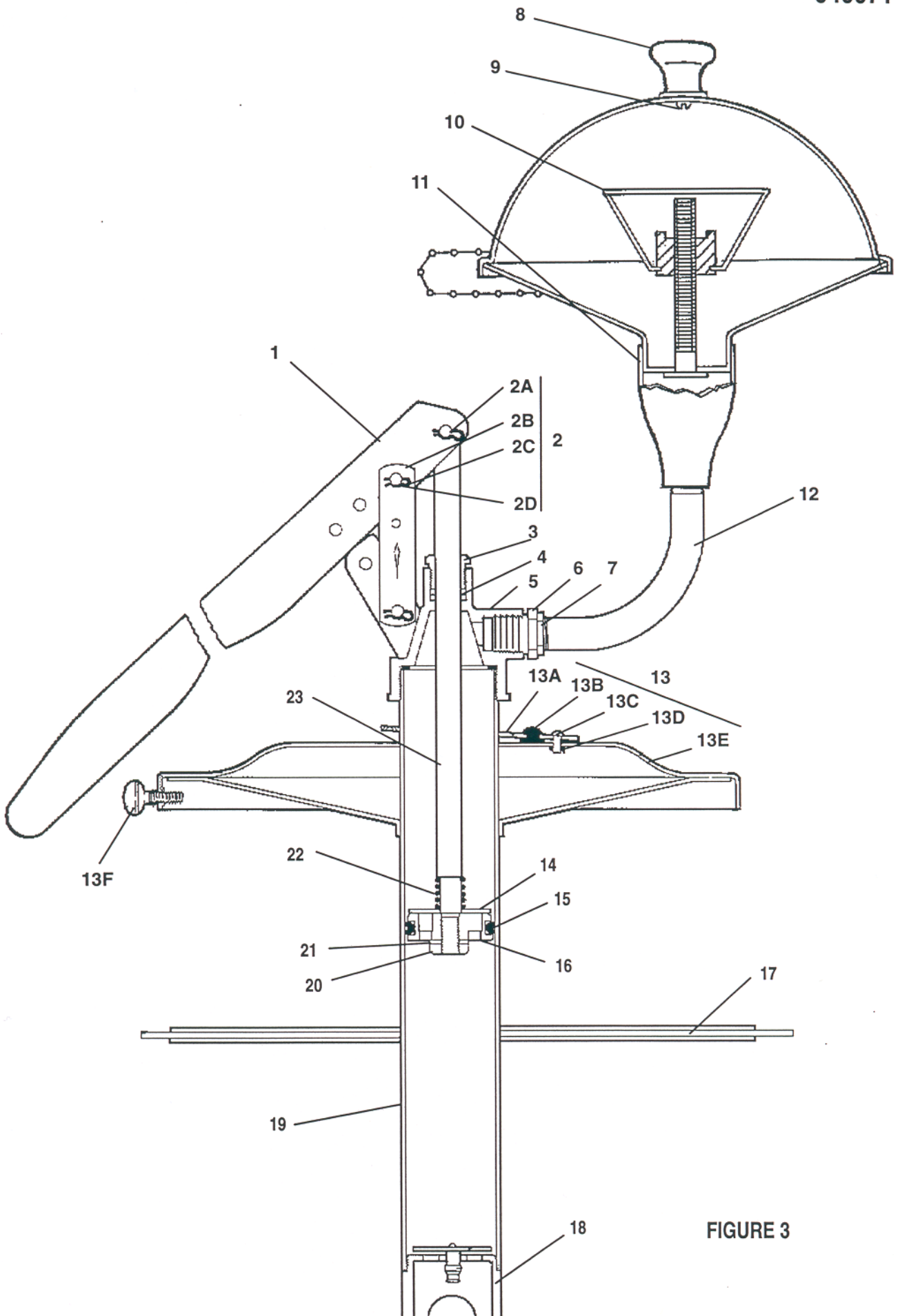



---

## OPERATION

---

- With the unit installed on bucket of grease, operate (1) hand lever six or eight strokes or until grease flows from bearing backer outlet. (See Figure 3).
- The unit is now ready for operation. Unscrew (10) Cone Assembly and place bearing onto fitting to be lubricated. Replace (10) Cone Assembly and Cover. Squeeze handle a number of times to build pressure. When handle goes slack, it is time to recharge unit.

---

## MAINTENANCE

---

- Disassembly should be done on a clean work bench with clean cloths to keep parts clean.
- If replacement parts are necessary, consult parts list for identification. Periodically flush pump with a solvent that is compatible with material being pumped.
- Caution should be used at all times to maintain clean lubricants and fluids, to avoid contaminated liquids passing through foot valve and damaging piston rod assembly.

---

## TROUBLESHOOTING

---

- If the pump fails to operate, check the (15) seal and (19) tube for damage or obstructions.
- If pump operates, but does not dispense lubricant. Check the (14) plate to see if it is clean of foreign particles, that will keep it from seating properly. Also check the plate of the (18) Foot Valve Body for damage.
- If leakage occurs between (23) piston rod and (3) nut, tighten nut just enough to stop leakage. **DO NOT OVERTIGHTEN** as this will cause excessive packing wear and increase force required to operate pump.



Part of worldwide Ingersoll-Rand

PN97999-026